

## Indigenous Vascular Plants of Huatoki Scenic Reserve, New Plymouth

Original list by BR Clarkson & MR Boase (1982) with recent additions compiled by JT Efford and BD Clarkson (February 2013)

<i>Adiantum cunninghamii</i>	Common maidenhair
<i>Adiantum fulvum</i>	Maidenhair
<i>Alectryon excelsus</i>	Titoki
<i>Aristotelia serrata</i>	Makomako, wineberry
<i>Asplenium bulbiferum</i>	Hen and chicken fern, pikopiko
<i>Asplenium flaccidum</i>	Hanging spleenwort
<i>Asplenium oblongifolium</i>	Shining spleenwort
<i>Asplenium polyodon</i>	Sickle spleenwort
<i>Astelia solandri</i>	Perching lily
<i>Austroderia fulvida</i>	Toetoe
<i>Beilschmiedia tawa</i>	Tawa
<i>Blechnum chambersii</i>	Lance fern
<i>Blechnum discolor</i>	Crown
<i>Blechnum filiforme</i>	Thread fern
<i>Blechnum fluviatile</i>	Creek fern, kiwikiwi
<i>Blechnum membranaceum</i>	
<i>Blechnum novae-zelandiae</i>	Kiokio
<i>Brachyglottis kirkii</i>	Kohurangi, Kirks daisy
<i>Brachyglottis repanda</i>	Rangiora
<i>Calystegia sepium</i>	Pink bindweed
<i>Calystegia tuguriorum</i>	Climbing convolvulus, NZ bindweed
<i>Cardamine debilis</i> agg.	NZ bittercress
<i>Carex dissita</i>	Forest sedge
<i>Carex secta</i>	Pukio
<i>Carex virgata</i>	Swamp sedge
<i>Centella uniflora</i>	
<i>Clematis paniculata</i>	White clematis, puawananga
<i>Collospermum hastatum</i>	
<i>Collospermum microspermum</i>	
<i>Coprosma areolata</i>	Thin-leaved coprosma
<i>Coprosma grandifolia</i>	Kanono
<i>Coprosma robusta</i>	Karamu
<i>Coriaria arborea</i>	Tutu
<i>Corynocarpus laevigatus</i>	Karaka
<i>Cyathea dealbata</i>	Silver fern, ponga
<i>Cyathea medullaris</i>	Mamaku, black tree fern
<i>Dacrycarpus dacrydioides</i>	Kahikatea, white pine
<i>Dacrydium cupressinum</i>	Rimu, red pine
<i>Dicksonia squarrosa</i>	Wheki
<i>Diplazium australe</i>	
<i>Drymoanthus adversus</i>	
<i>Dysoxylum spectabile</i>	Kohekohe, New Zealand mahogany
<i>Earina autumnalis</i>	Easter orchid, raupeka
<i>Earina mucronata</i>	Spring orchid
<i>Epilobium nummulariifolium</i>	Willowherb
<i>Epilobium pallidiflorum</i>	Swamp willowherb
<i>Epilobium rotundifolium</i>	Round-leaved willowherb

<i>Freycinetia banksii</i>	Kiekie
<i>Fuchsia excorticata</i>	Kotukutuku, tree fuchsia
<i>Geniostoma ligustrifolium</i> var. <i>ligustrifolium</i>	Hangehange
<i>Griselinia lucida</i>	Puka
<i>Haloragis erecta</i>	Toatoa, fireweed
<i>Hebe stricta</i> var. <i>macroura</i>	Koromiko
<i>Hedycarya arborea</i>	Porokaiwhiri, pigeonwood
<i>Histiopteris incisa</i>	Water fern
<i>Hoheria sexstylosa</i>	Houhere, lacebark
<i>Huperzia varia</i>	Hanging clubmoss
<i>Hydrocotyle microphylla</i>	
<i>Hymenophyllum demissum</i>	Drooping filmy fern
<i>Hymenophyllum dilatatum</i>	Filmy fern
<i>Hymenophyllum flabellatum</i>	Filmy fern
<i>Hymenophyllum revolutum</i>	Filmy fern
<i>Hymenophyllum sanguinolentum</i>	Filmy fern
<i>Hymenophyllum scabrum</i>	Rough filmy fern
<i>Ichthyostomum pygmaeum</i>	Pygmy tree orchid
<i>Isolepis habra</i>	
<i>Juncus edgariae</i>	
<i>Knightia excelsa</i>	Rewarewa, NZ honey suckle
<i>Lastreopsis glabella</i>	Smooth shield fern
<i>Lastreopsis hispida</i>	Hairy fern
<i>Laurelia novae-zelandiae</i>	Pukatea
<i>Leptopteris hymenophylloides</i>	Crape fern
<i>Lophomyrtus bullata</i>	Ramarama
<i>Loxogramme dictyopteris</i>	Lance fern
<i>Macropiper excelsum</i>	Kawakawa
<i>Melicytus ramiflorus</i>	Mahoe, whitey wood
<i>Metrosideros diffusa</i>	Climbing rata
<i>Metrosideros fulgens</i>	Climbing rata
<i>Metrosideros perforata</i>	White rata
<i>Microlaena avenacea</i>	Bush rice grass
<i>Microlaena stipoides</i>	Slender rice grass
<i>Microsorium pustulatum</i>	Hounds tongue
<i>Microsorium scandens</i>	Fragrant fern
<i>Microtis unifolia</i>	Onion-leaved orchid
<i>Mida salicifolia</i>	Willow-leaved maire, maire taïke
<i>Muehlenbeckia australis</i>	Large-leaved muehlenbeckia
<i>Myrsine australis</i>	Mapau, mapou, red matipo
<i>Nematoceras trilobum</i>	Spider orchid
<i>Nertera depressa</i>	
<i>Nestegis lanceolata</i>	White maire
<i>Oplismenus imbecillus</i>	
<i>Oxalis exilis</i>	Creeping oxalis, yellow oxalis
<i>Parsonsia capsularis</i>	Small-flowered jasmine
<i>Parsonsia heterophylla</i>	NZ jasmine
<i>Passiflora tetrandra</i>	Kohia, New Zealand passionfruit
<i>Pittosporum cornifolium</i>	Tawhirikaro
<i>Pneumatopteris pennigera</i>	Gully fern

<i>Poa anceps</i>	Broad-leaved poa
<i>Podocarpus totara</i>	Totara
<i>Polyphlebium venosum</i>	Veined bristle fern
<i>Prumnopitys ferruginea</i>	Miro, brown pine
<i>Pseudopanax arboreus</i>	Five finger, whauwhaupaku
<i>Pseudopanax crassifolius</i>	Horoeka, lancewood
<i>Pteridium esculentum</i>	Bracken
<i>Pteris macilenta</i>	Sweet fern
<i>Pteris tremula</i>	Shaking or tender brake
<i>Pterostylis banksii</i>	Tutukiwi, greenhood
<i>Ptisana salicina</i>	King fern, para
<i>Pyrrosia eleagnifolia</i>	Leather-leaf fern
<i>Ranunculus reflexus</i>	Hairy buttercup
<i>Rhopalostylis sapida</i>	Nikau palm
<i>Ripogonum scandens</i>	Supplejack
<i>Rumohra adiantiformis</i>	
<i>Rytidosperma unarede</i>	Bristle grass
<i>Schefflera digitata</i>	Pate, seven finger
<i>Senecio rufiglandulosus</i>	
<i>Solanum aviculare</i>	Poroporo
<i>Solanum nodiflorum</i>	Small-flowered nightshade
<i>Sophora microphylla</i>	Kowhai
<i>Thelymitra longifolia</i>	White sun orchid
<i>Tmesipteris elongata</i>	Fork fern
<i>Tmesipteris tannensis</i>	Fork fern
<i>Uncinia ferruginea</i>	Bastard grass, Cavers beard
<i>Uncinia uncinata</i>	Hook sedge
<i>Vitex lucens</i>	Puriri
<i>Weinmannia racemosa</i>	Kamahi
<i>Winika cunninghamii</i>	Winika, Pekapeka

#### **Planted / naturalised natives**

<i>Agathis australis</i>	Kauri
<i>Dodonaea viscosa</i>	Akeake
<i>Hoheria populnea</i>	Lacebark, houhere, ribbonwood
<i>Litsea calicaris</i>	Mangeao
<i>Olearia albida</i>	
<i>Olearia furfuracea</i>	Akepiro
<i>Phylocladus trichomanoides</i>	Tanekaha, celery pine
<i>Pittosporum crassifolium</i>	Karo
<i>Pittosporum eugenioides</i>	Tarata, lemonwood
<i>Pittosporum tenuifolium</i>	Kohukohu, black matipo
<i>Pomaderris apetala</i>	Tainui, New Zealand hazel
<i>Sophora tetraptera</i>	Kowhai, large-leaved kowhai

# TARANAKI LAND DISTRICT CITY OF NEW PLYMOUTH

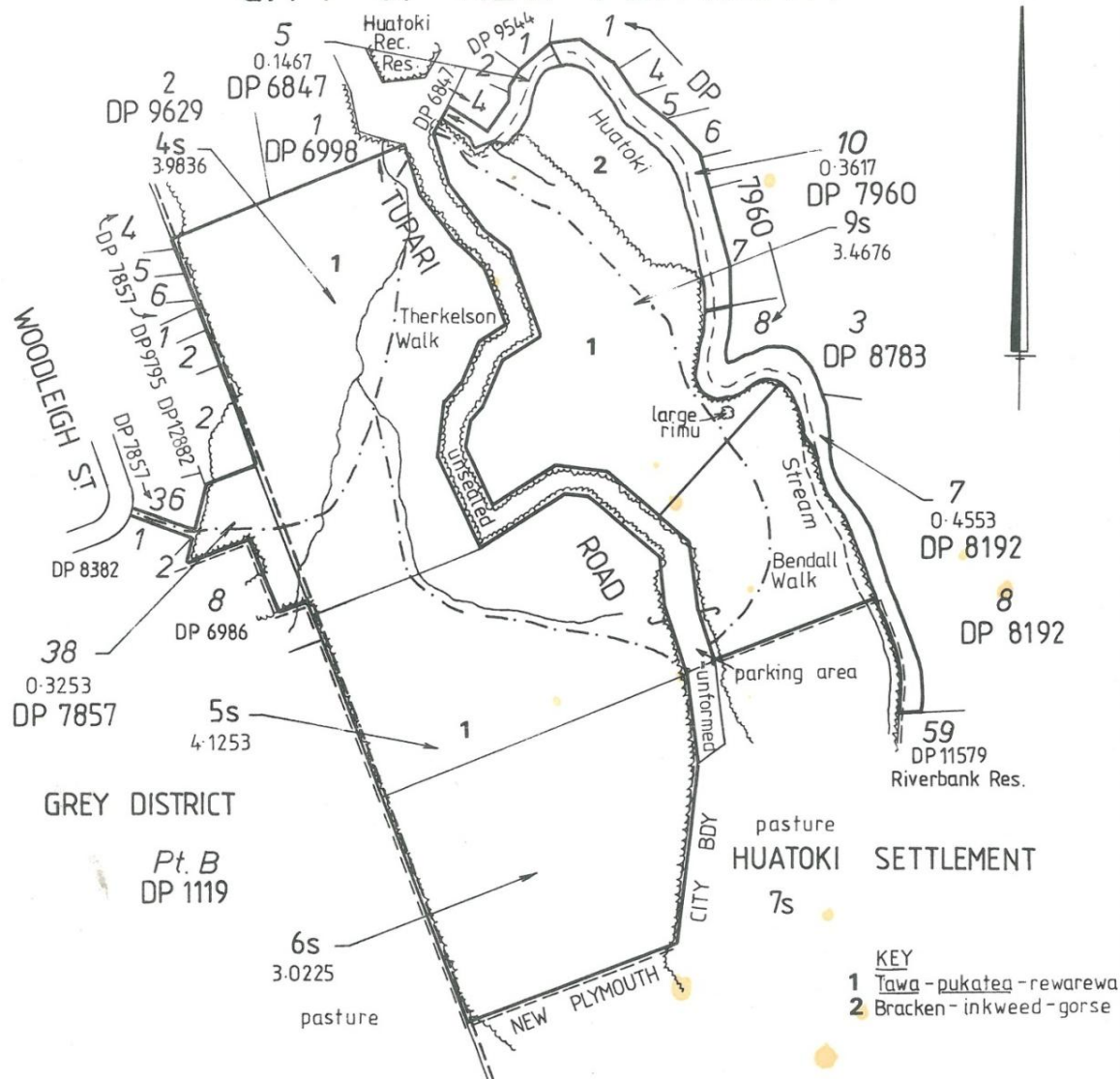

## HUATOKI SCENIC RES.

Lot 5 DP 6847, Lot 38 DP 7857, Lot 10 DP 7960, Lot 7 DP 8192, and Sections 4s, 5s, 6s, and 9s Huatoki Settlement.

107

Total Area - 15-8880 ha.

50 0 50 100 150 200 250

BLOCK V

PARITUTU SURVEY DISTRICT

SCALE 1:4000

LOCAL AUTHORITY NEW PLYMOUTH CITY

TARANAKI LAND DISTRICT

DRAWN

CHECKED

DATE

FILE

REF PLAN DP 7960/8192 AIR PHOTOS



HUATOKI		GRID REF	N109 652885
for: scenery <input checked="" type="checkbox"/> bush <input checked="" type="checkbox"/> scrub/tussock etc <input type="checkbox"/> wetland <input type="checkbox"/> plants <input type="checkbox"/> animals <input type="checkbox"/> geology/soil <input type="checkbox"/> history/prehistory <input type="checkbox"/> water supply <input type="checkbox"/>			
LOCATION	New Plymouth city, 3km south of New Plymouth Post Office.		
ACCESS	From Tupari Road, Huatoki Street or Woodleigh Street.		
OUTLINE & TOPO	A sizeable semi-coastal forest remnant on the outskirts of New Plymouth. The reserve is situated on flat to rolling terrain on the western side of the Huatoki Stream. The vegetation comprises mainly tawa and some rewarewa on the ridges with pukatea common in the gullies. Two well formed walks are present.		
SURROUNDINGS	Bush remnants on gully sides, houses, Huatoki Recreation Reserve to north, farmland to south.		
GEOLOGY	Taranaki Volcanic Region; Maitahi lahars. Dissected volcanic landscape.		
SPM	Egmont ash.		
SOIL	Yellow-brown loams; New Plymouth brown loam.		
DRAINAGE	Good on ridges and slopes.		
AREA ha/ac	15.8880		
L.D. No.	107		
STATUS	Scenic Reserve		
RES sub-Cttee			
CONTROL	CCL New Plymouth		
GAZETTED	1981 p.3231		
RESERVED	1921 p.2489		
HISTORY	Formerly part of Huatoki Recreation Reserve which was reserved in 1921		
AIR PHOTO date	5010 D/6 1976		
nearby town	New Plymouth		
nearest reserve	Cantlop		
public road	0		
sea (km)	3		
ALTITUDE m/ft	45-75m 150-250 ft		
ASPECT	North-east		
RAIN mm/in (approx)	1650mm 64 in		
NAT FERTILITY	Medium		

RES NOT		MAIN HABITATS and FEATURES										% area	area ha	native		ex	regen	NAT	trans	exotic
DT	CT	CT	CT	CT	CT	CT	CT	CT	CT	CT	CT			1 <sup>st</sup>	2 <sup>nd</sup>					
✓	✓											94	14.9	✓	✓		M	M	S	L
<p>1. Tawa-pukatea-rewarewa. Canopy generally up to 20m comprising mainly tawa and pukatea along with some rewarewa. Tawa is prominent on the drier ridge sites while pukatea is more common in the wetter gully sites. Titoki and kohekohe (generally subcanopy) are also common in places while a relatively large patch of karaka and puriri occurs along the north-east boundary. A number of natives which do not naturally occur in the reserve have been planted near the northern entrance. These include <i>Pomaderris apetala</i> (some seedlings noted), <i>Olearia alba</i> and kauri. Common understorey species include hangehange, kawakawa and nikau while <i>Thelypteris pennigera</i> and <i>Rumohra hirsuta</i> dominate the ground cover. Good regeneration of titoki, kohekohe, pukatea, rewarewa and tawa was noted; also significant puriri regeneration. Along the south and south-east boundary the undergrowth is quite sparse as a result of recent cattle browsing and trampling. Wandering Jew is common on the lower terraces along the banks of the Huatoki Stream.</p> <p>A large emergent rimu occurs on the eastern boundary and a good view of this tree can be gained from Huatoki Street at the top of the hill adjacent to the reserve.</p>																				
												6	0.9	✓	✓		L	L	D	H
<p>2. Bracken-inkweed-gorse. An untidy area which, until recently, supported a pine plantation. It is now dominated by problem plants such as bracken, inkweed, gorse and woolly nightshade which overtop rank growth of pasture grasses, particularly cocksfoot. A few isolated trees of rewarewa and pukatea also occur.</p>																				
												100	15.8							

CONDITION	Good in majority of bush. Problem weeds such as wandering Jew, traveller's joy, inkweed and gorse common in open areas and on bush margins. Human pressure evident.		
FENCING	Fence along S-SW boundary from Tupari Road to Woodleigh Street needs repairing.		
PRIORITY	High.		
RATING 0-10			
SCIENTIFIC	5	Semi-coastal forest remnant.	
SCENIC	6	High ranking due to view over reserve and adjacent bushclad areas from lookout points on Huatoki Street.	
RECREATION	4	Pleasant well-marked tracks through reserve. Parking at end of Tupari Road.	

**CONCLUSIONS and RECOMMENDATIONS**

A pleasant and popular reserve within New Plymouth city limits. Originally part of Huatoki Recreation Reserve, steps are at present (February, 1981) being taken to classify the area south of Huatoki Street as scenic. Two pleasant walks make up a loop track through the reserve; the Bendall Walk, established in 1925, forms the eastern half of the loop and the Therkelson Walk completes the loop to the west. The Therkelson Walk is particularly attractive as it passes by groves of nikau and large king fern, and a particularly tall pukatea individual (25+m) growing beside the stream.

It is a pity that signs of public abuse of the reserve are common throughout; household rubbish tipped over the gully side east of Huatoki Stream, litter strewn at the end of Tupari Road, old car bodies dumped, walk information signs missing and trees wilfully damaged. These features detract much from the present value of the reserve and should be remedied as soon as possible. Regular

maintenance will be necessary, at least initially, and the appointment of an honorary ranger to keep a close eye on the reserve should be considered.

...3. hours .....line..... conditions 5.2.81

BRC MRB LJH

NATURALNESS

TREND: D deteriorating; S steady; I improving

A small picnic area with picnic tables and chairs could be developed at the end of Tupari Road which is the popular parking area. Rubbish bins should also be provided as an attempt to solve the present litter problem.

Habitat 2 should be planted up in native trees (which occur naturally in the reserve) so that eventually the weed problem in this area is overcome.

Plot data from two sites, each 400m<sup>2</sup> in area, located in the reserve was supplied by B D Clarkson in 1979 (D.O. File 8/71, folio 1617). The information comprises a species list for the sites sampled as well as a ranking of the dominant species in terms of their contribution to each of the vegetation layers. Clarkson commented on the presence of large numbers of the small epiphytic orchids *Polypodium pumilum* and *Drymoanthus diversus* in the forest remnants and on isolated trees in the camping ground (Huatoki Recreation reserve).

#### REFERENCES

% area	SUMMARY	HABITATS												ORGANISMS		INFER		OBSERVED			
		WATER / SHORE												a - adjoins reserve		N	S	N	L	M	H
	tall conifer <sup>1</sup> forest/trees	a = adjoins reserve												higher native plants	109	120					
	conifer <sup>2</sup> forest/trees													lower plants							
94	beech forest/trees													exotic plants	37						
	BL <sup>3</sup> forest/trees													bush							
	scrub/shrubs <6m													exotic plants							
	tall tussocks/grassland													in native							
	short tussocks/grassland													higher freshwater plants							
	grassland/grasses													lower freshwater plants							
	sedge/land/sedges													native mammals							
	rush/land/rushes/raupo													native birds							
	herb/land/herbs													introduced birds							
	"tussock" herb/land													waterfowl s.l.							
	fern/land/ferns													introduced waterfowl							
	"moss" land													reptiles							
	bracken													native/introduced amphibia							
	exotic grassland													fw native fish							
	exotic herb/land/woodland													fw introduced fish							
	exotic scrub/shrubs													fw invertebrates							
	exotic forest/trees													terrestrial invertebrates							
	introduced "native" cover													saltwater life							
	bag/swamp/pakihi																				
	marsh sw/fw																				
	mudflat sw/fw																				
	bluff/rocks																				
	bluffs/rocks in bush																				
	waterfall																				
	cave/gorge																				
	gravel habitat/scree																				
	dune/sand																				
	limestone																				
	ultrabasics																				
	geological site																				
	breeding ground																				
	rare/interesting animals																				
	rare/interesting plants																				
	historic site																				
	historic building																				
	prehistoric site																				
	camp / midden / pits																				

	terrace/earthworks burial/tepu	picnic + water ditto + car boating	other lease	N	S	M	A	J		burnt < 25 years burnt > 25 years fire risk			
100			unnatural noise visual pollution		✓		rubbish				GCK	✓	
	tall conifer: <i>kahikatea</i> , <i>kauri</i> , <i>matai</i> , <i>miro</i> , <i>rimu</i> , <i>torara</i>		<sup>2</sup> remaining 11 tree-sized spp			<sup>3</sup> broadleaved	<sup>4</sup> e.g. flax		<sup>5</sup> incl. rough grassland, pasture etc				